



ProjectReady®

*Project Management & Document Control
with SharePoint*

The NEW ProjectReady Central Preview

Introducing ProjectReady™ Central



- **ProjectReady Central** is the latest release of ProjectReady software delivering a state-of-the-art user interface & experience with more features & accessibility than ever before.
- **ProjectReady Central** uniquely addresses digital disruption & the ever-expanding number of cloud services by unifying silo'd data into a single, consistent, modern user experience – ending content chaos.
- **ProjectReady Central** takes a series of complex, & labor intensive business functions & creates a governed, simple, & intuitive business solution.
- **ProjectReady Central** represents a high value solution that addresses project management & document control requirements that drive revenue & efficiency.

Project Name	Project Number	Created Date	Project Manager	Project Type	Status
IBM Research Facility	1001	5/26/2017	Shail Modi		Open
Test Crail	999	6/2/2017	Vishal Dhole		Open
Moulton Street Renovations	20000000	4/20/2017	Jesse Maggione		Open
Johnson & Johnson Research Center	0420	4/20/2017	Jesse Maggione		Open
Balchott Park Revision	200011.01	6/1/2017	Vishal Dhole		Open
Children's Hospital Expansion	0011743.11	5/17/2017	Kathryn Roses		Open
Norris Telecom Headquarters	20C2002.01	5/1/2017	Jesse Maggione		Open
Faulkner Clinic	0994638.82	6/5/2017	Kathryn Roses		Open
Moulton Street Renovations	2002002.00	5/22/2017	Joseph M. Gingrich		Open
Cambridge YMCA	1996005.00	5/26/2017	Jesse Maggione		Open
City Hall Facade Replacement	1999005.00	5/17/2017	Lindsay Minocci		Open

Action	Task Name	Project Number	Project Name	Client	Assigned To	Project Manager	Start Date	Due Date	Priority	Period Cost
Design Finalization		0501	Cape Cod Industrial Office Park	R7 Enterprises LLC	smo@ggj-works.com	lismock@ggj-works.com	6/5/2017	6/15/2017	(2) Normal	0.00
Review Questions for Contract		0501	Cape Cod Industrial Office Park	R7 Enterprises LLC	smo@ggj-works.com	lismock@ggj-works.com	5/15/2017	5/18/2017	(2) Normal	0.00
Review Questions for Contract		0501	Cape Cod Industrial Office Park	R7 Enterprises LLC	smo@ggj-works.com	lismock@ggj-works.com	5/15/2017	5/18/2017	(2) Normal	0.00
Review Questions for Contract		0501	Cape Cod Industrial Office Park	R7 Enterprises LLC	smo@ggj-works.com	lismock@ggj-works.com	5/15/2017	5/18/2017	(2) Normal	0.00
Test		0420	Johnson & Johnson Research Center	ABB Construction Inc.	tparrison@ggj-works.com	jmaggione@ggj-works.com	5/10/2017	5/11/2017	(2) Normal	0.00
100 CDs		1995007.00	North River Environment Test Laboratory	North Shore Alliance Group	smo@ggj-works.com	smo@ggj-works.com	6/5/2017	4/4/2017	(2) Normal	0.00
80 CDs		1995007.00	North River Environment Test Laboratory	North Shore Alliance Group	smo@ggj-works.com	smo@ggj-works.com	6/5/2017	1/26/2017	(2) Normal	0.00
Apply for research permit		1995007.00	North River Environment Test Laboratory	North Shore Alliance Group	ggisac@ggj-works.com	smo@ggj-works.com	5/30/2017	6/6/2017	(1) High	50.00
Approve Lab Drawings		1995007.00	North River Environment Test Laboratory	North Shore Alliance Group	ggisac@ggj-works.com	smo@ggj-works.com	5/30/2017	6/15/2017	(2) Normal	0.00
Red awarded		1995007.00	North River Environment Test Laboratory	North Shore Alliance Group	smo@ggj-works.com	smo@ggj-works.com	6/5/2017	5/25/2017	(2) Normal	0.00
Red awarded		1995007.00	North River Environment Test Laboratory	North Shore Alliance	smo@ggj-works.com	smo@ggj-works.com	6/5/2017	5/25/2017	(2) Normal	0.00

About ProjectReady™



- **ProjectReady** addresses the specific needs of project-driven organizations including the AEC Industries, Legal Firms & departments & all Professional Services Organizations
- **ProjectReady** was developed by Gig Werks, an award-winning SharePoint solution provider, based on 10 years and 12,000+ thousand hours of development of solutions for Project Management and document control
- With the advances in Cloud Technology, **ProjectReady** was formed as company to take that expertise and subject matter knowledge to develop from the ground up a first in class, Enterprise Solution
- Being a SaaS solution, **ProjectReady** is constantly delivering new features and updates to continuously drive consistent value to its customers
- **ProjectReady** has grown globally, with clients throughout North America, Europe and the Middle East





ProjectReady®



Leverage SharePoint & the Microsoft Cloud

On-Premise & Hybrid Support & Integration

Seamless Integration into Line of Business Systems

ProjectReady – Ending Content Chaos

In the modern age of cloud and digital disruption, more than ever it's all about the user experience. ProjectReady Demystifies complex processes and business processes regardless of where information resides in the enterprise

Ease of Use
Modern UX & UI

Automated Project
Site Creation

Easy Access to All
Your Project Sites

Centrally Manage
All Tasks, Projects &
Resources

Document Control,
Management &
Distribution

External Access &
Security

Line of Business &
Project Accounting
Integration

Visibility &
Reporting Across all
Projects & Tasks

Information
Architecture built
to scale

Outlook Integration
Email Management

Resource
Management

Change Order
Management

ProjectReady Central Components



Project Management

The ProjectReady Project Management interface displays a list of projects with columns for Project Name, Start Date, End Date, and Status. Below this, a resource management Gantt chart shows tasks assigned to various resources over time, with columns for days of the week and specific dates.

Document Control

The ProjectReady Document Control Suite interface shows options to 'Select Package Type', 'Package Details', and 'Add Documents to Package'. Below, a table lists documents with columns for Name, Modified, Current Type, Designer, Drawing Number, Drawing Type, Sheets, File Size, and Model Size. A separate section titled 'Document Control - Outstanding Transmittals' includes a 'Drill Down' list, a 'Totals' summary (338 Outstanding Transmittals, 69 Outstanding Transmittals), and a line graph showing trends over time.

Outlook Integration

The Outlook integration screenshot shows an email interface with a ProjectReady E-mail header. The email content includes a 'Question' about steel type, an 'Answer' with a link to an RFI folder, and a task assignment for 'Task Assigned: RFI Approval - GW0005-RFI-113'. The interface also shows 'My projects' and 'E-Mail Type' dropdown menus.

ProjectReady Central Project Management



- Be it one or a thousand projects, from a single location you can manage, edit and create ALL your projects, tasks, approvals, documents & resources
- Easily set site security and permissions for all your projects from one place driving secure internal & external collaboration
- Governed and secure creation of collaborative projects sites by business users
- Best practices information architecture built to scale automatically
- Bring together information from Project Accounting & Line of Business systems to one central interface for easy management
- Rich & comprehensive reporting across all projects, tasks & resources

The image displays three screenshots of the ProjectReady software interface. The top screenshot shows a 'My Projects' view with a table of project details including project name, location, start date, and status. The middle screenshot shows a 'Portfolio Activities - Communication' view with a table of communication activities, including subject, type, and status. The bottom screenshot shows a 'Resource Management' view with a Gantt chart showing resource allocation across different projects and tasks over time.

ProjectReady Central Document Control



- Centrally manage & create **RFI's, Transmittals, Submittals & Change Orders**, securely delivered inside and outside your organization for review and approval
- Establish enterprise communication standards that are consistent, reliable and repeatable across every project throughout the enterprise
- Simplify the assembly of document packages across systems with an easy-to-use shopping cart experience
- Rich & comprehensive reporting across all enterprise document communications
- Consolidated, single view of the status of all key document communications
- Cover sheets for all document packages created automatically

The screenshot displays the ProjectReady Document Control Suite interface. The top section shows a 'Create Package' button and a 'Select Package Type' dropdown. Below this, there are four main actions: 'RFI' (Request for Information), 'Transmittal' (Request for proposal documents sent internally to clients and vendors), 'Submittal' (Request for proposal documents sent internally to members of your organization), and 'Change Order' (Create a change order for review of transmittals). The interface also includes a 'Package Details' section and an 'Add Documents to Package' button.

The middle section shows a 'Select Source' dropdown and a 'Browse' button. Below this is a table of documents with columns for Type, Name, Modified, Content Type, Discipline, Drawing Revision, Drawing Type, Version, File Size, and Model Status.

Type	Name	Modified	Content Type	Discipline	Drawing Revision	Drawing Type	Version	File Size	Model Status
RFI	RFI - General Requirements List	10/22/2018 10:22 AM	RFI	RFI	01	RFI	01	47000	Transmittals/Transmittals
RFI	RFI - 2nd Floor	10/22/2018 10:22 AM	RFI	RFI	01	RFI	01	12700	Transmittals/Transmittals
RFI	RFI - 201808201_2nd Floor	10/22/2018 10:22 AM	RFI	RFI	01	RFI	01	178700	Transmittals/Transmittals
RFI	RFI - 2nd Floor	10/22/2018 10:22 AM	RFI	RFI	01	RFI	01	178700	Transmittals/Transmittals
RFI	RFI - 2nd Floor	10/22/2018 10:22 AM	RFI	RFI	01	RFI	01	178700	Transmittals/Transmittals

The bottom section shows a 'Document Control - Outstanding Transmittals' report. It includes a 'Drill Down' section with a list of clients, a 'Totals' section showing 338 Outstanding Transmittals and 69 Overdue Transmittals, and a line graph showing the number of outstanding transmittals over time. The graph shows a significant peak in late May/early June.

Bringing it All Together in Outlook



- Save attachments & emails to your Project Sites at the click of a button from Outlook
- Assign Tasks from emails to your Project sites directly from Outlook
- Maintain control of your project data by un-siloing emails, documents and correspondence from Outlook
- Drive Reporting and Analysis of your email and matters
- Tag & Route emails to be managed as necessary (i.e.: Meeting Notes, Addendums & Meeting Minutes)
- Create and manage requests for information (RFI's) from Outlook

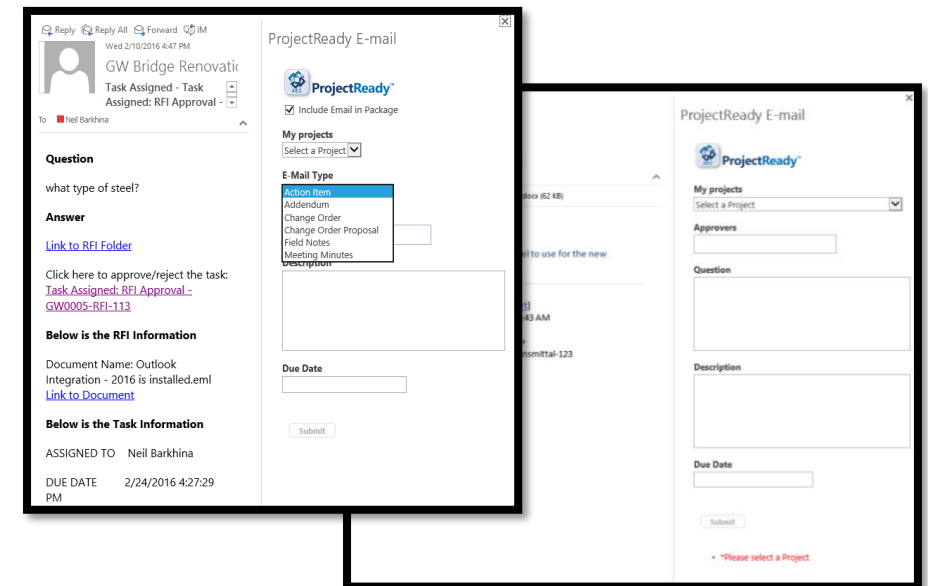
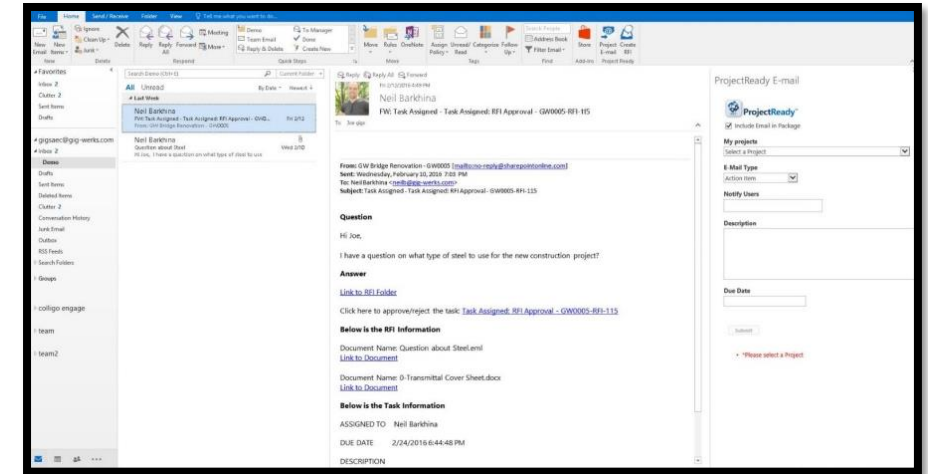



ProjectReady[®]

***The NEW ProjectReady Central
Preview Demonstration***

Questions & Answers

**Go to the Question Tab on your GoToWebinar Control Panel and
Type Your Questions to be Answered**

**Please *Do Not Forget* to fill out the survey as you leave the webcast
to receive Today's PowerPoint & Webcast Recording**

Contact Us

www.Project-Ready.com

www.Gig-Werks.com

info@project-ready.com

914-207-1110